





LANARK COUNTY

**File# B22/030 &
B22/031**

Landowner: Wayne Currie

**Subject Land: Pt Lot 1&2, CON
2 geographic Township of
Pakenham now in Mississippi
Mills Township**

-  **Proposed Severance
B22/030**
-  **Proposed Severance
22/031**
-  **Subject Property**
-  **Parcel Fabric**

APPLICATION FOR CONSENT
"Sketch Only"
*Prepared by Lanark County
Planning Dept.*
NOT A LEGAL SURVEY

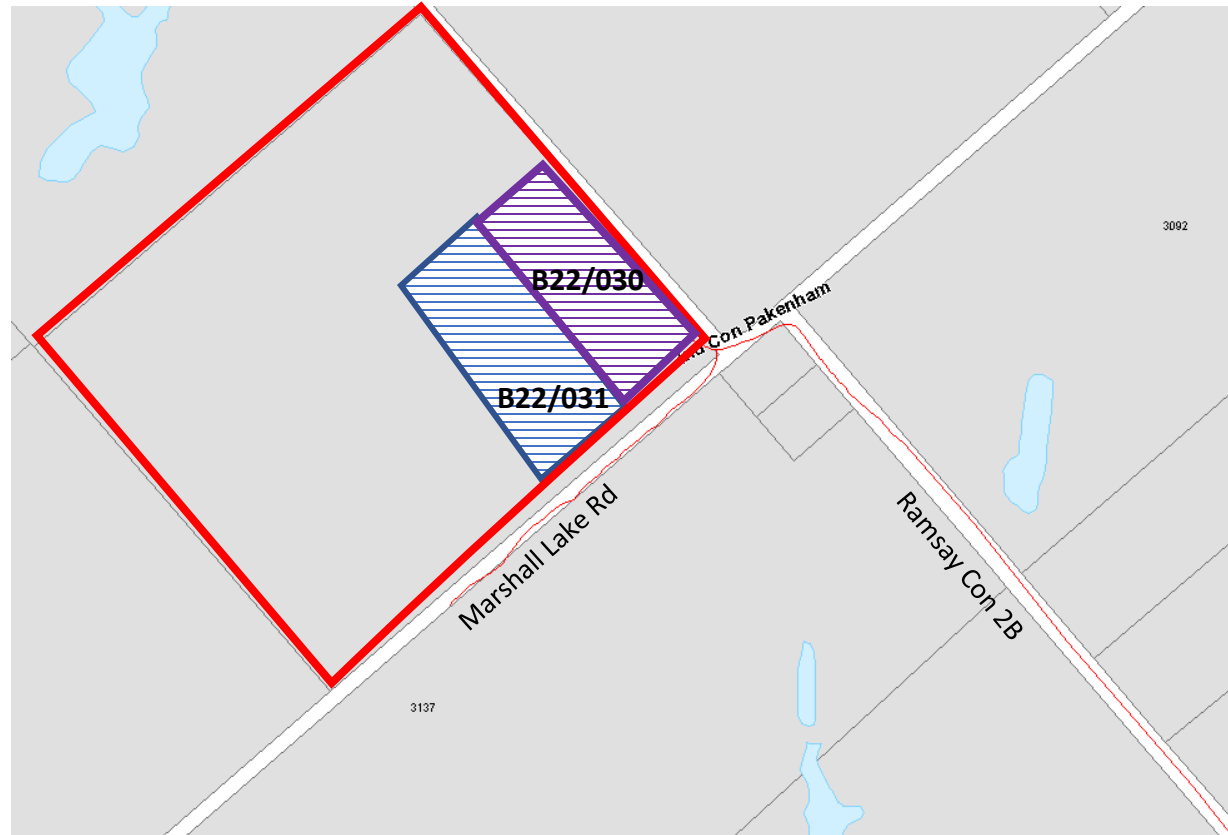

The above is for reference purposes only and may not be to scale – complete details are found in the application form.